

Plotted By: Hargrett, Tom Sheet Set: Charlotte Burrie Park Layout: L1.10 TREE DISPOSITION December 19, 2023 05:54:01pm K:\WEB_URG_043310008- Charlotte Burrie Park CAD\Plansheets\L1.00 Tree Disposition.dwg

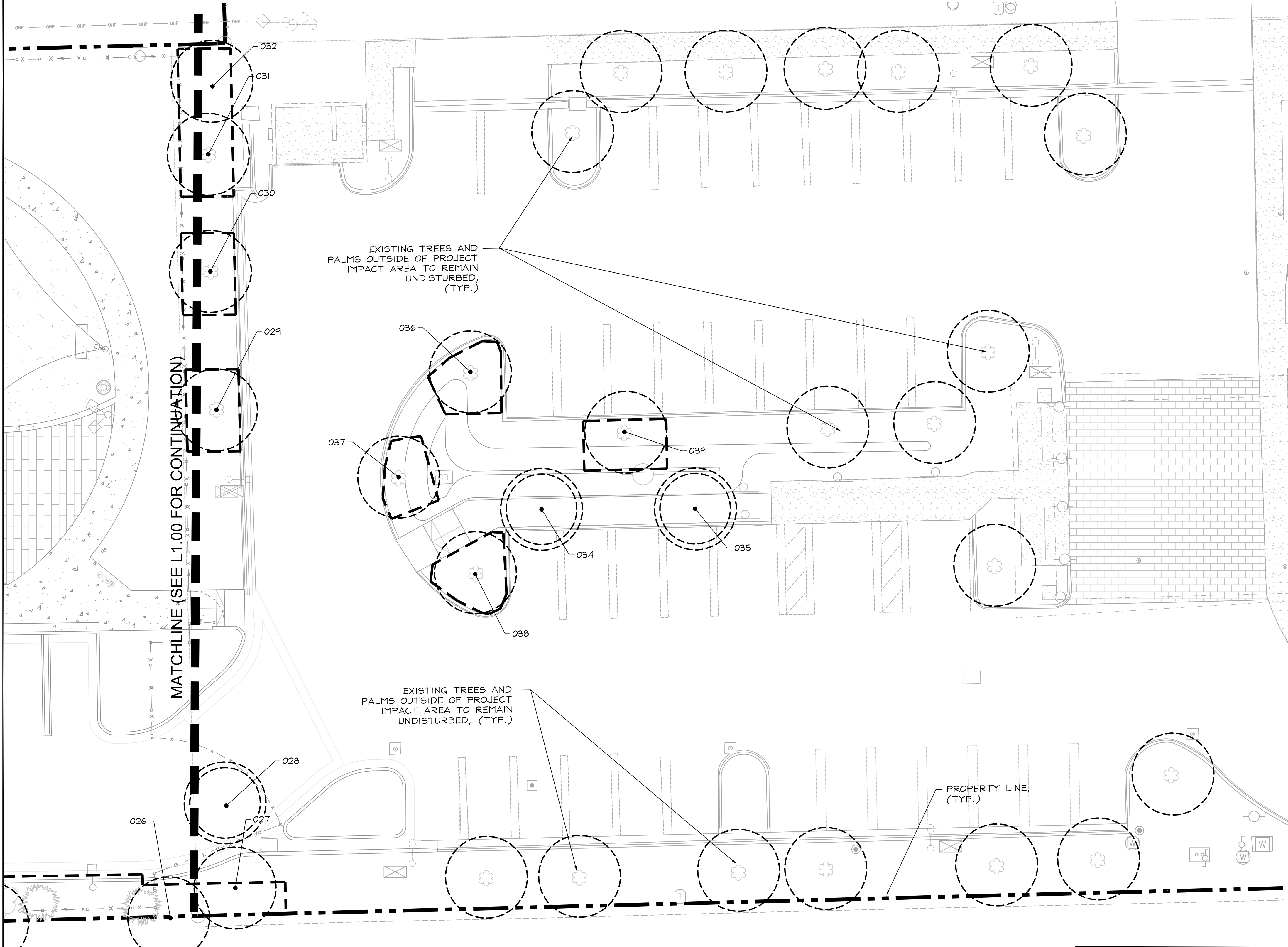

	Common Name	Scientific Name	DBH (in)	Height (in)	Condition Rating	SURVEY SHEET	Comments	Disposition	Appraised Value
1	Live Oak	Quercus virginiana	18	NA	80%	4	Specimen	Protect	\$3,392
2	Live Oak	Quercus virginiana	15	NA	85%	4		Protect	NA
3	Live Oak	Quercus virginiana	19	NA	80%	4	Specimen	Protect	\$3,718
4	Dead Tree	Dead Tree	7	NA	0%	4	Dead tree	Remove	NA
5	Cabbage Palm	Sabal palmetto	19	10	90%	4		Protect	\$405
6	*Carrotwood	Cupaniopsis anacardioides	7	NA	25%	4	Cat. 1 Invasive	Remove	NA
7	*Carrotwood	Cupaniopsis anacardioides	4	NA	0%	4	Cat. 1 Invasive	Remove	NA
8	*Brazilian Pepper	Schinus terebinthifolia	15	NA	0%	4	Cat. 1 Invasive	Remove	NA
9	Carrotwood	Cupaniopsis anacardioides	4	NA	0%	4	Cat. 1 Invasive	Remove	NA
10	Cabbage Palm	Sabal palmetto	14	18	85%	4		Protect	NA
11	*Carrotwood	Cupaniopsis anacardioides	5	0	0%	4	Cat. 1 Invasive	Remove	NA
12	Cabbage Palm	Sabal palmetto	13	20	90%	4		Protect	NA
13	*Carrotwood	Cupaniopsis anacardioides	6	NA	0%	4	Cat. 1 Invasive, dead tree	Remove	NA
14	Cabbage Palm	Sabal palmetto	17	24	80%	4		Protect	NA
15	*Carrotwood	Cupaniopsis anacardioides	3	NA	0%	4	Cat. 1 Invasive	Remove	NA
16	*Carrotwood	Cupaniopsis anacardioides	9	NA	0%	4	Cat. 1 Invasive	Remove	NA
17	*Carrotwood	Cupaniopsis anacardioides	4	NA	0%	4	Cat. 1 Invasive	Remove	NA
18	Cabbage Palm	Sabal palmetto	15	12	80%	4		Protect	NA
19	Strangler Fig	Ficus aurea	18	NA	50%	5		Remove	\$870
20	Cabbage Palm	Sabal palmetto	21	28	65%	5	Specimen	Protect	\$293
21	Cabbage Palm	Sabal palmetto	15	22	80%	5		Protect	NA
22	Cabbage Palm	Sabal palmetto	14	24	75%	5		Protect	NA
23	Cabbage Palm	Sabal palmetto	15	26	80%	5		Protect	NA
24	*Carrotwood	Cupaniopsis anacardioides	15	NA	0%	5	Cat. 1 Invasive	Remove	NA
25	Cabbage Palm	Sabal palmetto	18	26	55%	5	With Growing Umbrella Tree	Protect	\$248

TREE DISPOSITION SUMMARY	
TREES TO REMAIN:	12
TREES TO BE RELOCATED:	3
INVASIVE/DEAD TO BE REMOVED:	11
TREES TO BE REMOVED:	1
PALMS TO REMAIN:	12
PALMS TO BE RELOCATED:	0
PALMS TO BE REMOVED:	0

26	Cabbage Palm	Sabal palmetto	14	20	95%	5		Protect	NA
27	Silver Buttonwood	Conocarpus erectus v. sericeus	8	NA	90%	5	8 Multi-trunk	Protect	NA
28	Tipu Tree/Pride of Bolivia	Tipuana Tipu	6	NA	95%	5		Relocate	NA
29	Live Oak	Quercus virginiana	5	NA	90%	5		Protect	NA
30	Live Oak	Quercus virginiana	5	NA	95%	5		Protect	NA
31	Live Oak	Quercus virginiana	4	NA	95%	5		Protect	NA
32	Tipu Tree/Pride of Bolivia	Tipuana Tipu	6	NA	90%	5		Protect	NA
33	Cabbage Palm	Sabal palmetto	8	10	95%	4	"Pup"	Protect	NA
34	Gumbo Limbo	Bursera simaruba	9	NA	Not Provided			Relocate	Not Provided
35	Gumbo Limbo	Bursera simaruba	8	NA	Not Provided			Relocate	Not Provided
36	Wild Tamarind	Lusiloma latisiliquum	8	NA	Not Provided			Protect	Not Provided
37	Wild Tamarind	Lusiloma latisiliquum	7	NA	Not Provided			Protect	Not Provided
38	Wild Tamarind	Lusiloma latisiliquum	7	NA	Not Provided			Protect	Not Provided
39	Gumbo Limbo	Bursera simaruba	7	NA	Not Provided			Protect	Not Provided
Total Appraised									\$8,926

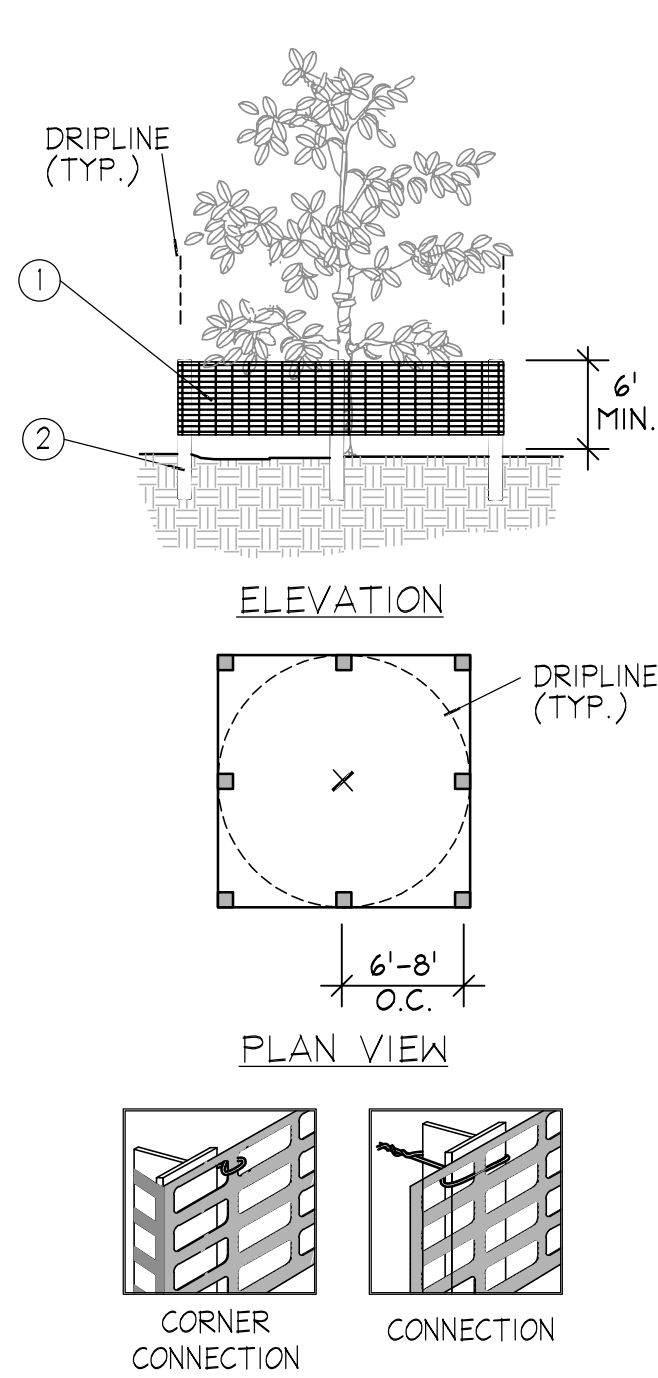

- ① 6'H "PERIMETER PLUS" CONSTRUCTION FENCE BY CONWED PLASTICS OR OWNER'S REPRESENTATIVE APPROVED EQUAL. SUBMIT PRODUCT INFORMATION FOR APPROVAL PRIOR TO INSTALLATION.
- ② 8' TALL METAL "I" POSTS OR 2" x 2" x 8' PRESSURE TREATED WOOD POSTS WITH 24" BURIAL BELOW GRADE.
- INSTALLATION NOTES:
- A. POST SELECTION SHOULD BE BASED ON EXPECTED STRENGTH NEEDS AND THE LENGTH OF TIME FENCE WILL BE IN PLACE. FLEXIBLE FIBERGLASS ROD POSTS ARE RECOMMENDED FOR PARKS, ATHLETIC EVENTS AND CROWD CONTROL INSTALLATIONS. METAL "I" POSTS OR TREATED WOOD POSTS ARE TYPICALLY USED FOR CONSTRUCTION AND OTHER APPLICATIONS.
- B. POSTS SHOULD BE DRIVEN INTO THE GROUND TO A DEPTH OF 1/4 OF THE HEIGHT OF THE POST. FOR EXAMPLE, A 8' POST SHOULD BE SET AT LEAST 2' INTO THE GROUND.
- C. SPACE POSTS EVERY 6' (MIN.) TO 8' (MAX.).
- D. SECURE FENCING TO POST WITH NYLON CABLE TIES (AVAILABLE FROM CONWED PLASTICS). WOOD STRIPS MAY BE ALSO BE USED TO PROVIDE ADDITIONAL SUPPORT AND PROTECTION BETWEEN TIES AND POSTS.
- NOTE: IF WIRE TIES ARE USED, AVOID DIRECT CONTACT WITH FENCE. WIRE MAY DAMAGE FENCE OVER TIME.

- ROOT PRUNING**
1. THE LANDSCAPE ARCHITECT HAS OBSERVED TREES THAT COULD BE IMPACTED BY CONSTRUCTION OF THE PROPOSED IMPROVEMENTS.
2. IF CONSTRUCTION ACTIVITIES OCCUR WITHIN THE DRIPLINE (OR THE HORIZONTAL EXTENT OF THE CANOPY) OF A TREE, THEN THAT TREE IS A CANDIDATE FOR ROOT PRUNING.
3. ROOT PRUNING MUST OCCUR PRIOR TO TRENCHING OPERATIONS TO INSURE THAT THE ROOTS ARE CUT CLEAN AND AT PROPER ANGLES AND NOT MECHANICALLY RIPPED FROM THE EARTH DURING CONSTRUCTION.
4. FOR TREES REQUIRING ROOT PRUNING, A TREE ASSESSMENT SHALL BE CONDUCTED AND A ROOT-PRUNING PLAN SHALL BE DEVELOPED BY A CERTIFIED ARBORIST OR CONSULTING ARBORIST. THIS PLAN SHOULD IDENTIFY:
- MAXIMUM ALLOWABLE SIZE OF ROOTS TO BE CUT
 - ALLOWABLE PROXIMITY TO THE TRUNK FOR CUTS
 - TIME OF YEAR WHEN ROOT CUTTING IS ALLOWABLE (NOTE: IN FLORIDA, IT IS BEST TO AVOID ROOT PRUNING DURING TIMES OF THE MAY THROUGH SEPTEMBER, WHEN THE POTENTIAL FOR DAMAGING WIND LOADS ON TREES ARE GREATEST.)
 - METHOD FOR MAKING CUTS
 - MITIGATING CANOPY PRUNING
 - TYPE AND EXTENT OF NECESSARY STRUCTURAL SUPPORT
 - SCHEDULE FOR WATERING/FERTILIZATION AFTER PRUNING
5. IMPLEMENT THE ROOT PRUNING PLAN PER THE ARBORIST'S RECOMMENDATION.
- TREE/PALM RELOCATION NOTES**
1. TREES/PALMS SHALL BE RELOCATED ONCE FROM THEIR PRESENT LOCATION TO A DESIGNATED LOCATION ON THE LANDSCAPE PLAN. RELOCATION ACTIVITIES WILL INCLUDE PLANTING ON SLOPES AND/OR LEVEL GRADE.
2. AN ISA - CERTIFIED ARBORIST OR A CERTIFIED LANDSCAPE CONTRACTOR CERTIFIED BY THE FLORIDA NURSERYMEN AND GROWERS ASSOCIATION SHALL PERFORM AND MONITOR ALL PALM ROOT PRUNING AND RELOCATION ACTIVITIES.
3. LANDSCAPE SPECIFICATIONS PROVIDED IN THIS CONSTRUCTION SET SHALL APPLY TO ALL RELOCATED TREES AND/OR PALMS.
4. CONTRACTOR SHALL STAKE AND GUY ALL PALMS AT THE TIME OF TRANSPLANT AS PER DETAILS PROVIDED IN THIS CONSTRUCTION SET. CONTRACTOR SHALL BE RESPONSIBLE FOR THE MAINTENANCE AND/OR REPAIR OF STAKING AND GUYING DURING THE WARRANTY PERIOD. ALL PALMS SHALL BE BRACED AT LEAST ONE (1) YEAR OR AS DIRECTED BY THE OWNER'S REPRESENTATIVE.
5. SOIL BACKFILL FOR THE INSTALLATION OF TREES/PALMS SHALL BE UNIFORM MIX OF 25% WELL-ROTTED COMPOST AND 75% CLEAN, WEED-FREE LOOSENEED NATIVE SOIL BACKFILL.
6. CONTRACTOR SHALL SUBMIT MANUFACTURERS CERTIFIED ANALYSIS FOR SOIL AMENDMENTS TO THE OWNER'S REPRESENTATIVE.
7. CONTRACTOR SHALL PAY TO HAVE THE BACKFILL LAB TESTED IF REQUESTED BY THE OWNER'S REPRESENTATIVE.
8. REFER TO STAKING DETAIL B AND F SHEET L2.II.

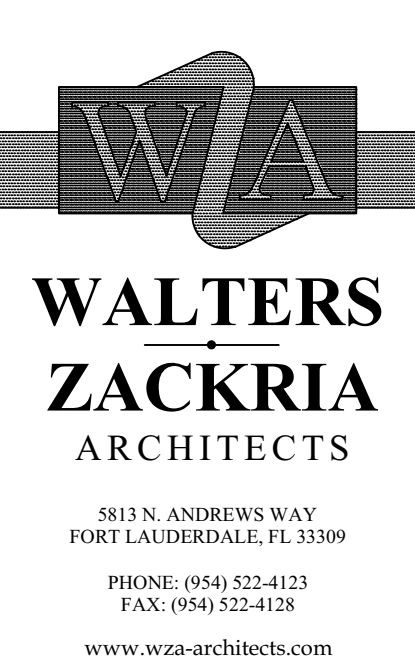
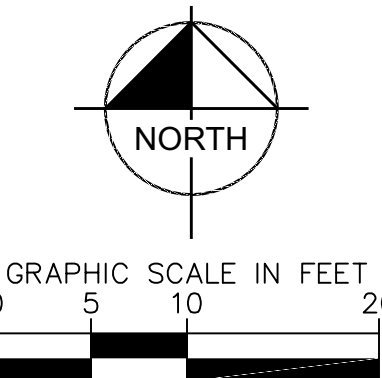
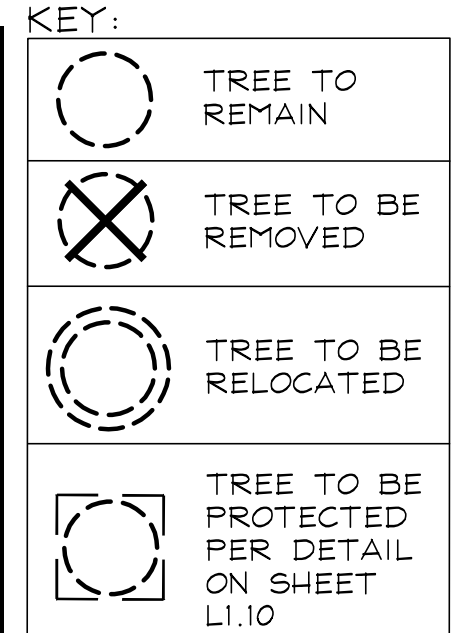

Abbas H. Zackria, FL AR 91520

CORPORATE NAME: WALTERS ZACKRIA ASSOCIATES, PLLC REGISTERED IN THE STATE OF FLORIDA. WRITTEN DIMENSIONS TAKE PRECEDENCE OVER SCALED DIMENSIONS. THESE DRAWINGS ARE THE PROPERTY OF WALTERS ZACKRIA ASSOCIATES, PLLC, AND SHALL NOT BE REPRODUCED WITHOUT WRITTEN PERMISSION FROM A PRINCIPAL OF THE FIRM OR BE LIABLE FOR THE FULLEST LEGAL RESOURCES. CONTRACTOR SHALL VERIFY ALL EXISTING CONDITIONS AND DIMENSIONS AND NOTIFY THE ARCHITECT OF ANY DISCREPANCIES PRIOR TO EXECUTION OF WORK.

CITY OF POMPANO BEACH
CHARLOTTE BURRIE COMM. CENTER
PLAZA AND PASSIVE PARK
2669 N FEDERAL HWY,
POMPANO BEACH, FL 33064

DRAWN BY: BM
CHECKED BY: TH
DATE: 12-22-2023
REVISIONS:
△ 10-23-23 PERMIT CO-ORD
△ 12-22-23 PERMIT CO-ORD

2203
L1.10
TREE DISPOSITION PLAN

AAC
PZ23-12000041
02/06/2024